



marbletrend

flinders shower panel

INSTALLATION GUIDE

DESIGN STYLE FUNCTION



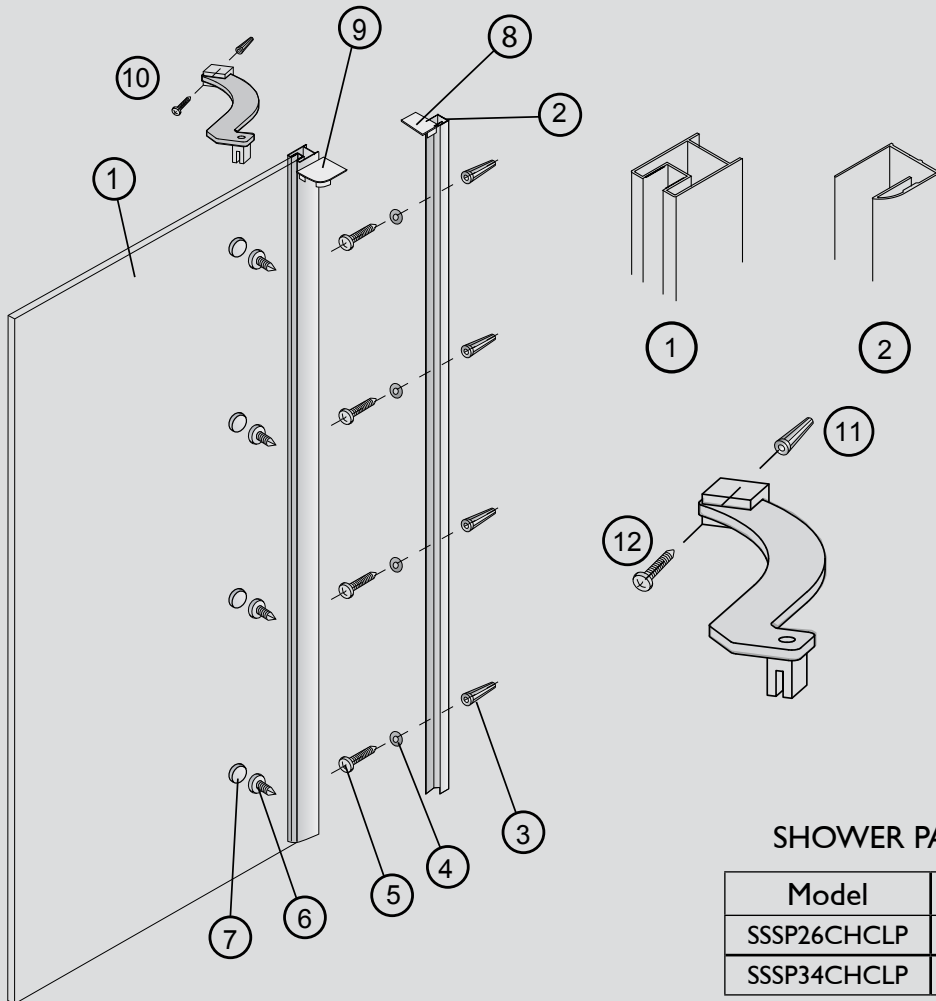

COMPONENT LIST

1. 1 x Fixed panel with jamb
2. 1 x Wall jamb
3. 4 x 6mm anchors
4. 5 x 4mm SS washers
5. 4 x 3.5x35 SS screws
6. 4 x 3.9x8 SS screws
7. 4 x Screw caps
8. 1 x Wall jamb cap
9. 2 x Side panel covers(L/R)
10. 1 x Support arm assembly
11. 1 x 8mm anchors
12. 1 x 5x45 SS screw

SHOWER PANEL MODELS

Model	Size
SSSP26CHCLP	2000 x 851 (+25)
SSSP34CHCLP	2000 x 1165 (+25)

STEP 1

- A) Place wall jamb (2) on wall make sure jam is level and plumb and mark holes
- B) Drill 4 x 6mm holes depth of 35mm in wall and insert 6mm anchors (3)
- C) Fix wall jamb using 4mm stainless steel washers (4) and 4 x 3.5x35 screws (5)

STEP 2

- A) Insert fixed panel (1) into wall jamb (2)
- B) Drill 4 x 3.2mm holes and fix panel to wall jam using 4 x 3.9x8 screws (6) and place plastic screw caps (7) over screw heads

STEP 3

- A) Place support arm in position on top of fixed panel then mark hole on wall and drill 8mm hole to a depth of 35mm and insert 8mm anchor (11)

- B) Fix support arm using 5x45mm stainless steel screw (12)
- C) Tighten grub screw to fixed panel to ensure panel is level and plumb

STEP 4

- A) Place wall jamb cap (8) on wall jam and cover (9) for fixed panel

STEP 5

- A) Apply silicone sealant around external joints only of wall jamb and fixed panel
- B) Allow 24hrs for silicone to set before using shower

WARRANTY This product is covered by a 1 year product replacement including labour and materials. Please refer to www.gemini-industries.net for full warranty terms

HEAD OFFICE (NSW)

2/97 BANKSIA ST
BOTANY NSW 2019
T. 1300 717 717
F. 1300 746 480

VICTORIA

T. 1300 717 717 F. 1800 225 315

QUEENSLAND

T. 1300 717 717 F. 1300 746 480

WESTERN AUSTRALIA

T. 1300 717 717 F. 1800 225 315

TASMANIA

T. 0428 223 116 F. 1800 225 315

SOUTH AUSTRALIA

T. 0499 221 201 F. 1800 225 315